

# *geodyna 980 L*

---

**Ersatzteilliste**  
**Spare parts list**  
**Liste des pièces détachées**

**Radauswuchtmaschine für LKW**  
**Wheel balancer for truck wheels**  
**Equilibreuse de roues de poids-lourds**

---

**HOFMANN**®



**HWT**  
**HNA: USA – CANADA**





**DIESER ABSCHNITT IST AUSSCHLIESSLICH DEM WARTUNGSFACH-UND KUNDENDIENSTPERSONAL VORBEHALTEN**

**THIS PART IS FOR EXCLUSIVE USE OF QUALIFIED PERSONNEL FOR MAINTENANCE AND SERVICE PURPOSES.**

**CETTE PARTIE EST RESERVEE AU PERSONNEL QUALIFIE ET AUTORISE A LA MAINTENANCE ET AU SERVICE APRES-VENTE.**

**QUESTA PARTE É AD USO ESCLUSIVO DEL PERSONALE QUALIFICATO ED AUTORIZZATO ALLA MANUTENZIONE ED ASSISTENZA.**

**ESTA PARTE ES PARA USO EXCLUSIVO DEL PERSONAL CALIFICADO Y AUTORIZADO PARA EL MANTENIMIENTO Y LA ASISTENCIA.**

**ESTA PARTE ES PARA USO EXCLUSIVO POR PESSOAL ESPECIALIZADO ED AUTORIZADO A LA MANUTENÇÃO**

- **Bei Auftragserteilung anzugeben:** Maschinentype, Serinnummer, Artikel-Code, Menge.
- **On order specify:** type of machine and serial number item code and quantity.
- **A la commande:** bien préciser le type de la machine, le n° de serie, la référence de pièce, la quantité.
- **All'ordine specificare:** tipo macchina e matricola, codice e quantità del particolare.
- **En cada pedido hay que especificar:** el tipo de máquina y su número de matricula, el número de código de la pieza requerida y su cantidad.
- **Na encomenda especificque:** tipo da máquina e número de série, codigo do item e quantidade.

Note:

Ex. **0011111** - BOLD TYPE CODES ON TABLES MEANS SUGGESTED SPARE PARTS

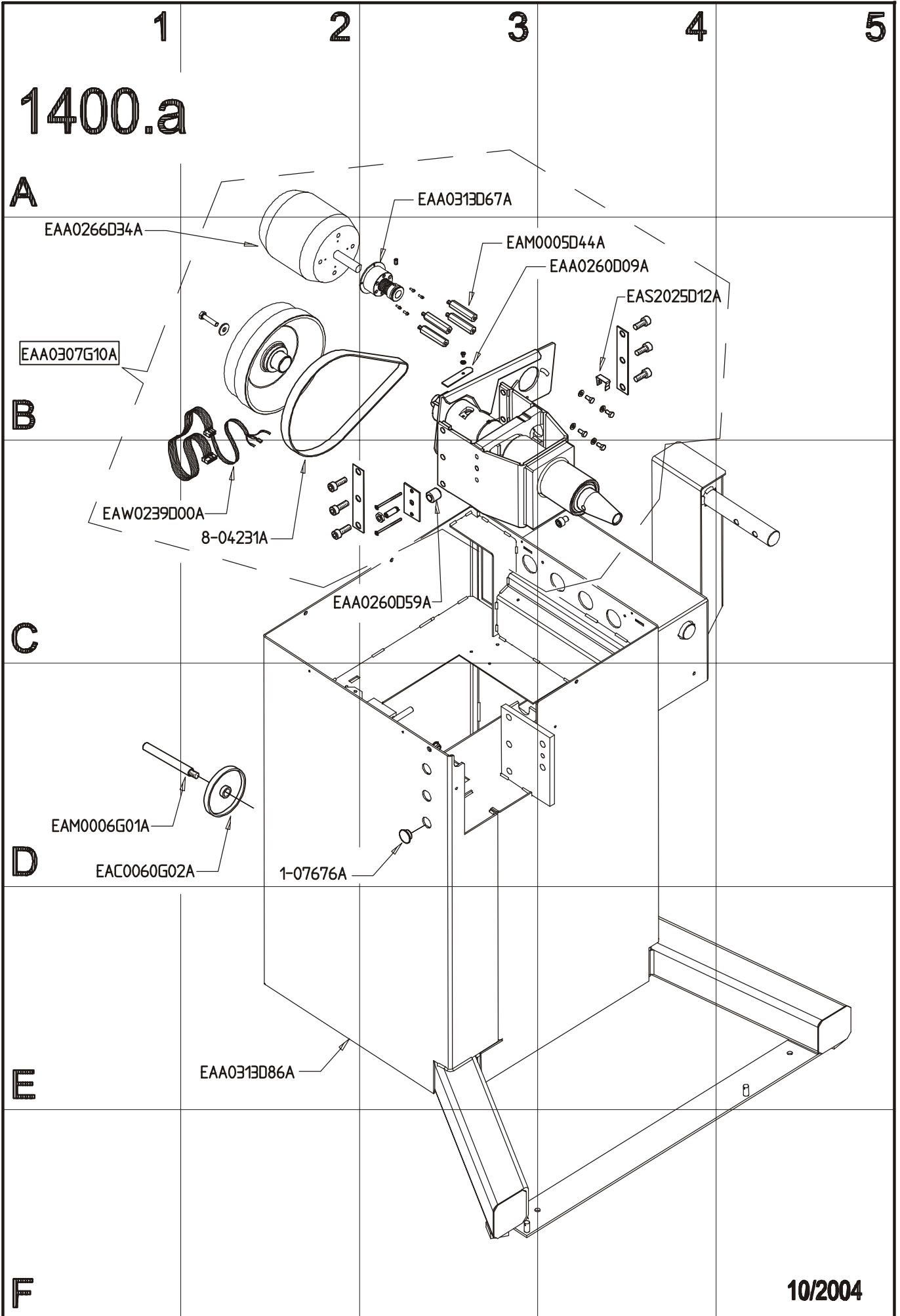

172-b-Oct-04

10/2004

1  
2  
3  
4  
5  
  
1401.a

A

B

C

D

E

F

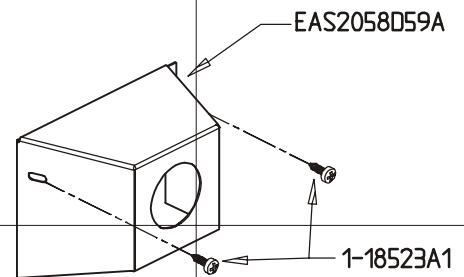
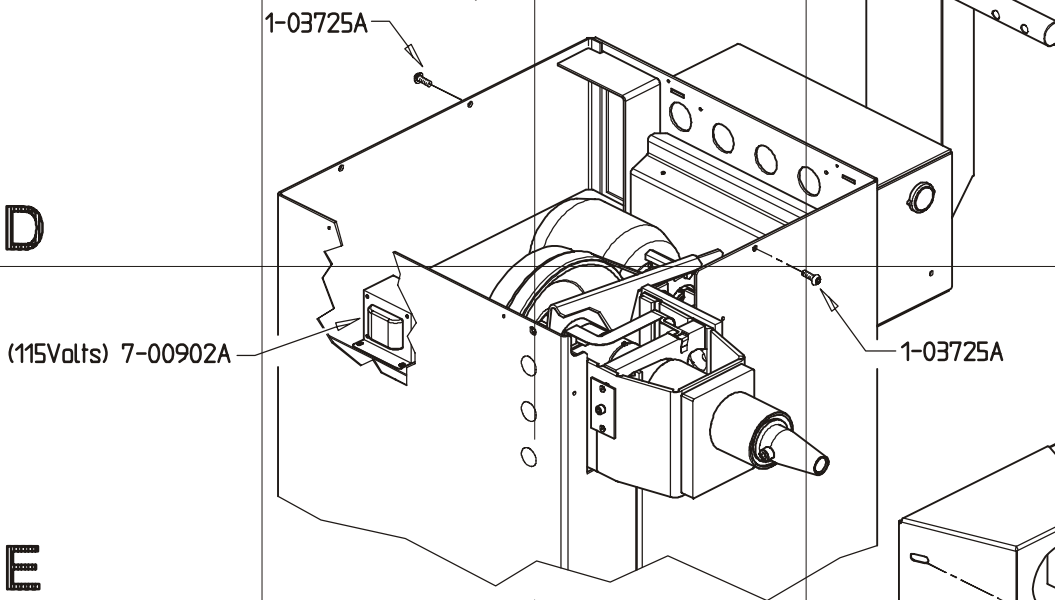
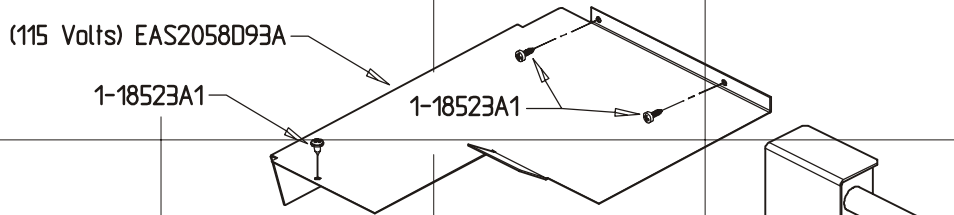
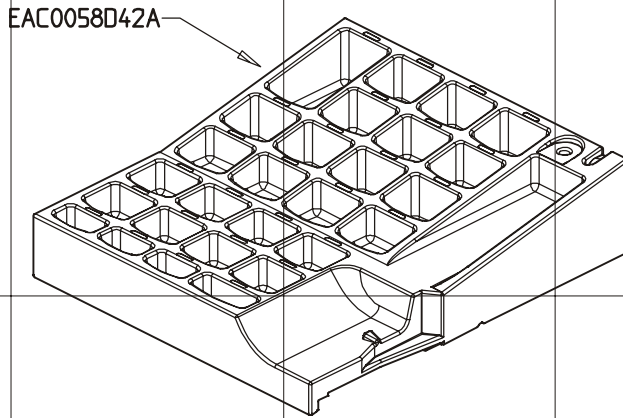

10/2004

1402.a

A

B

C

D

E

F

1

2

3

4

5

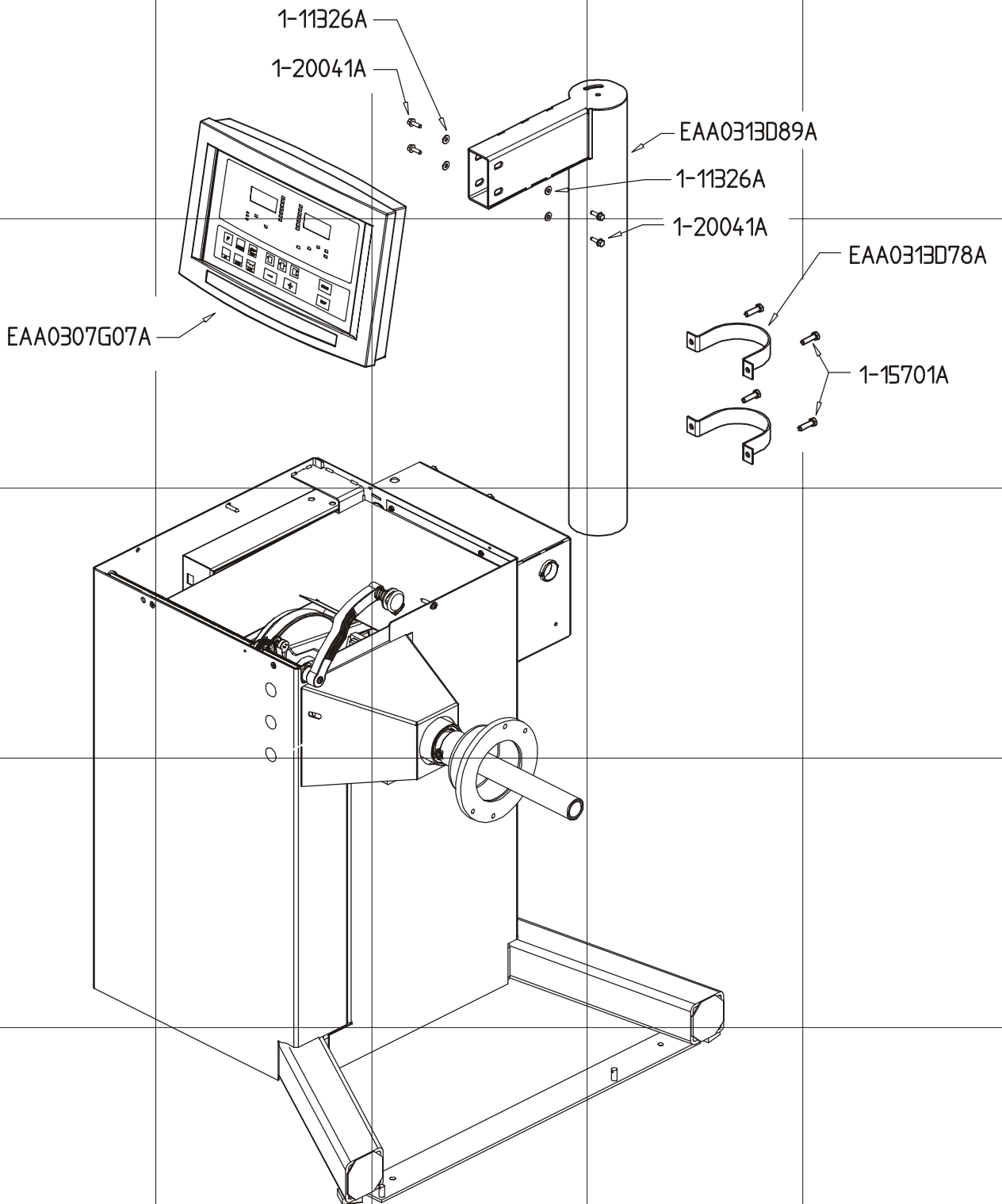

172-b-Oct-04

10/2004

6

5

4

3

2

1

1403.a

A

B

C

D

E

10/2004

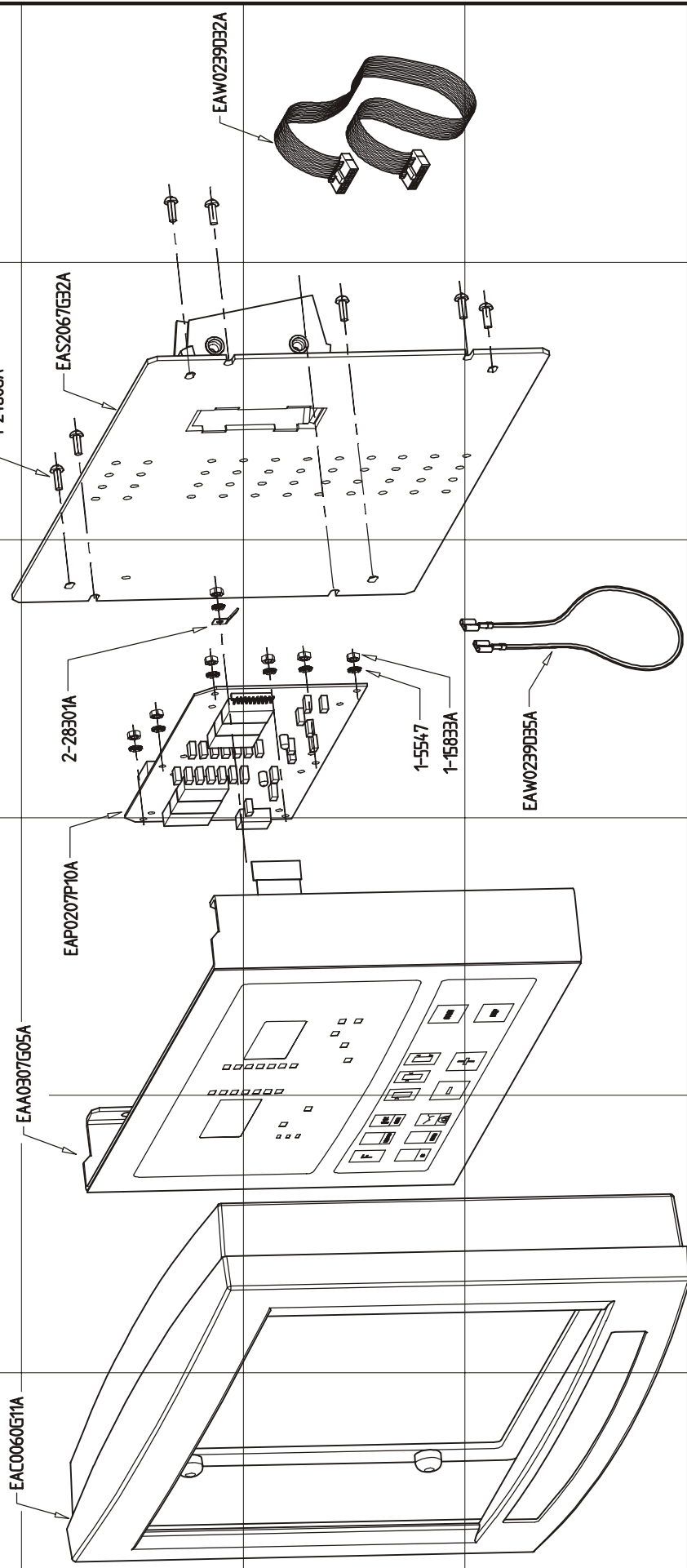

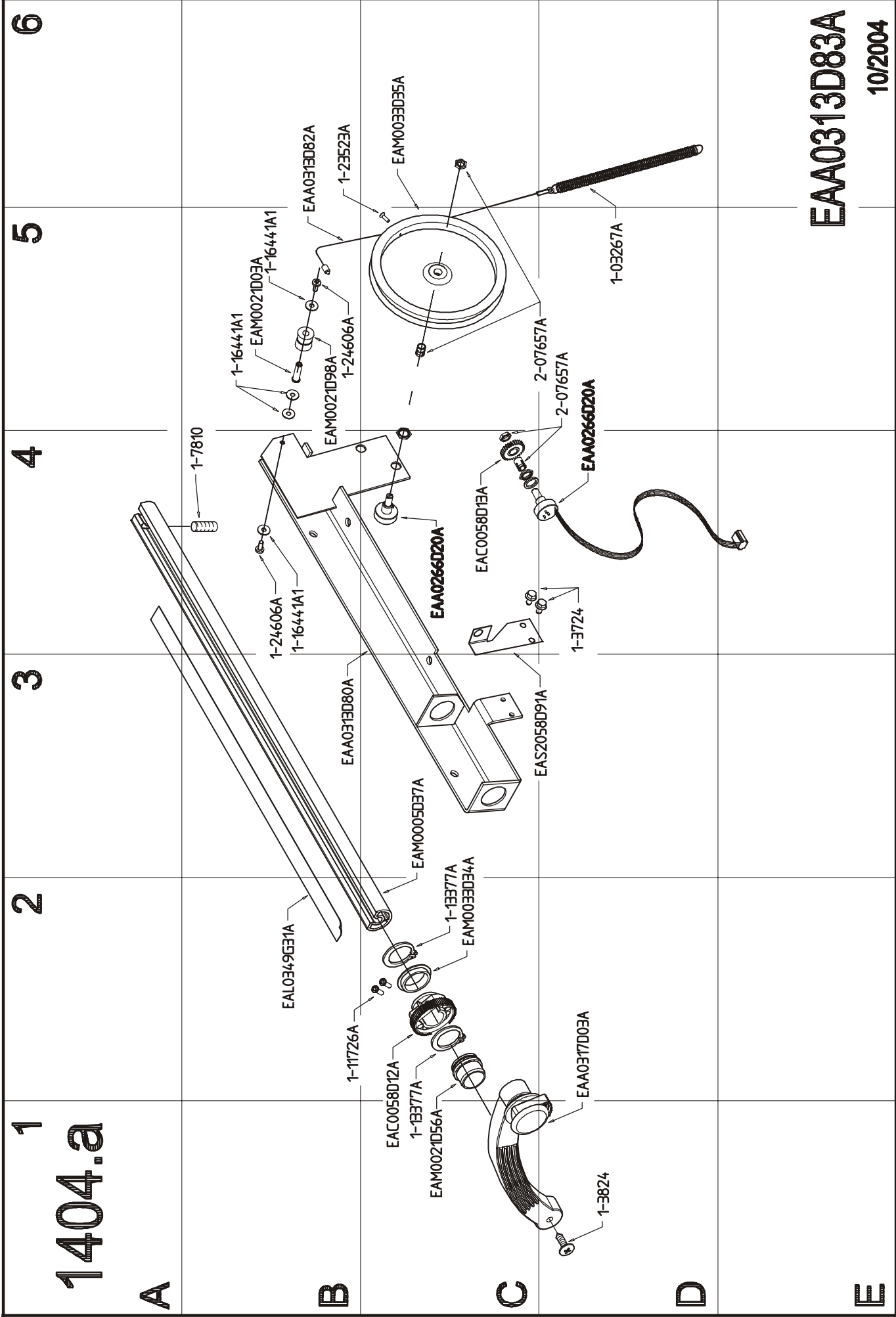

EAA0313D83A  
10/2004

E

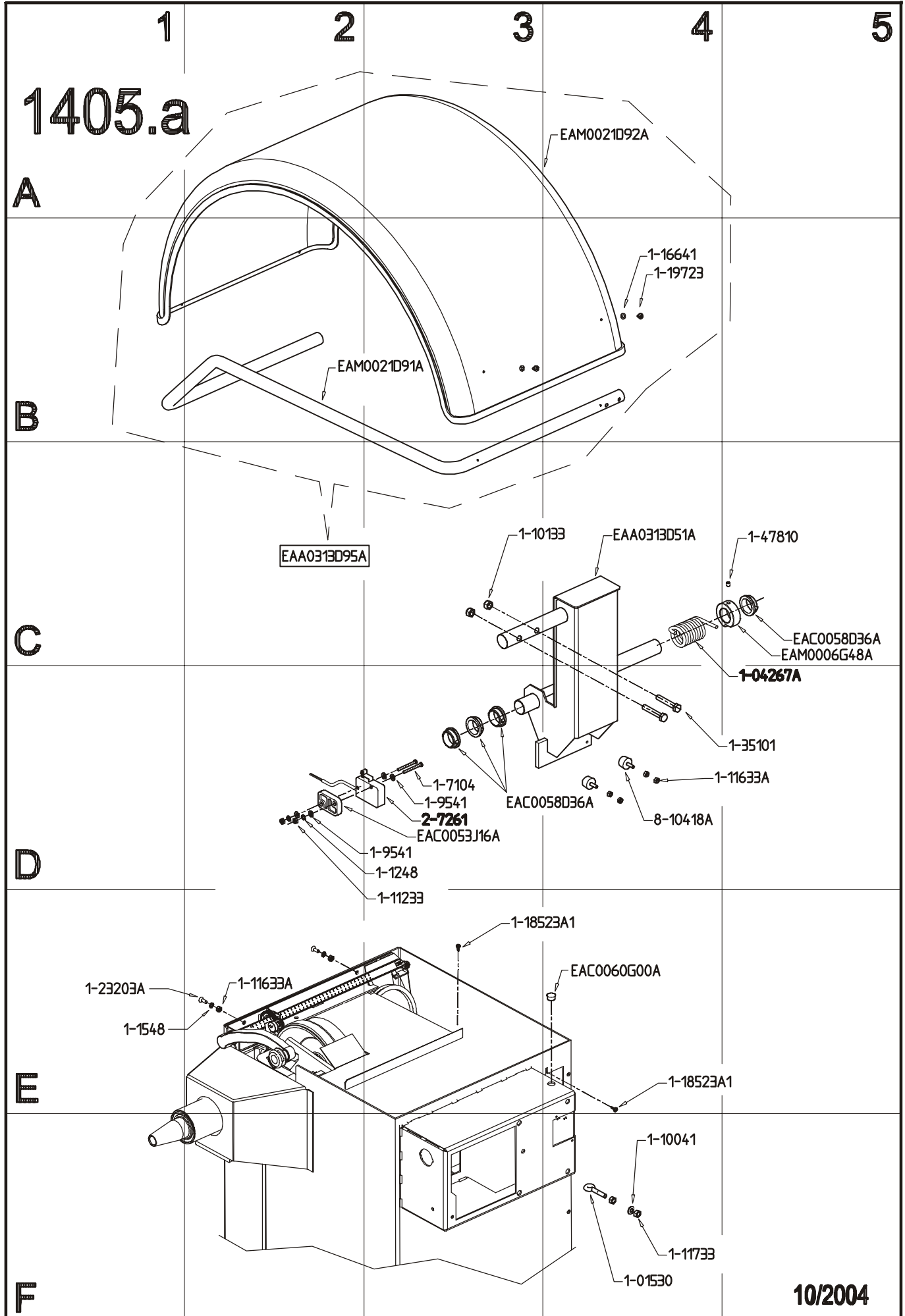

172-b-Oct-04

10/2004



# 1406.a

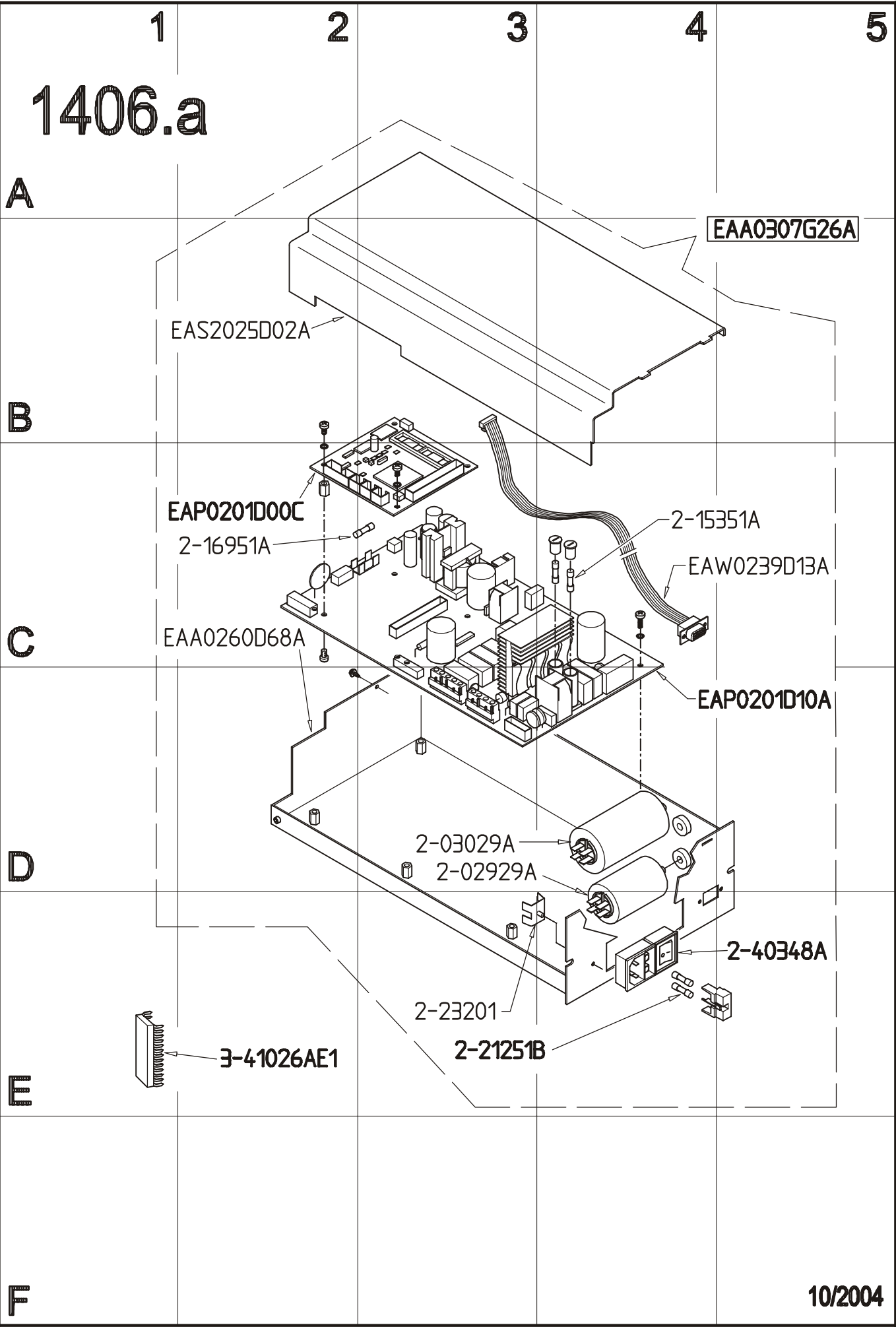

172-b-Oct-04

10/2004

1

2

3

4

5

1407.a

A

B

C

D

E

F

EAA0260D31A

EAA0317D24A

EAA0260D32A

EAA0260D36A

EAA0260D34A

1-16509A1

8-03550A

EAA0313D96A

8-01350A

8-02040A1

EAA0247G22A

8-00391A

10/2004

1  
1454.a

2 3  
**USA - CANADA**  
VERSION ONLY

4

5

A

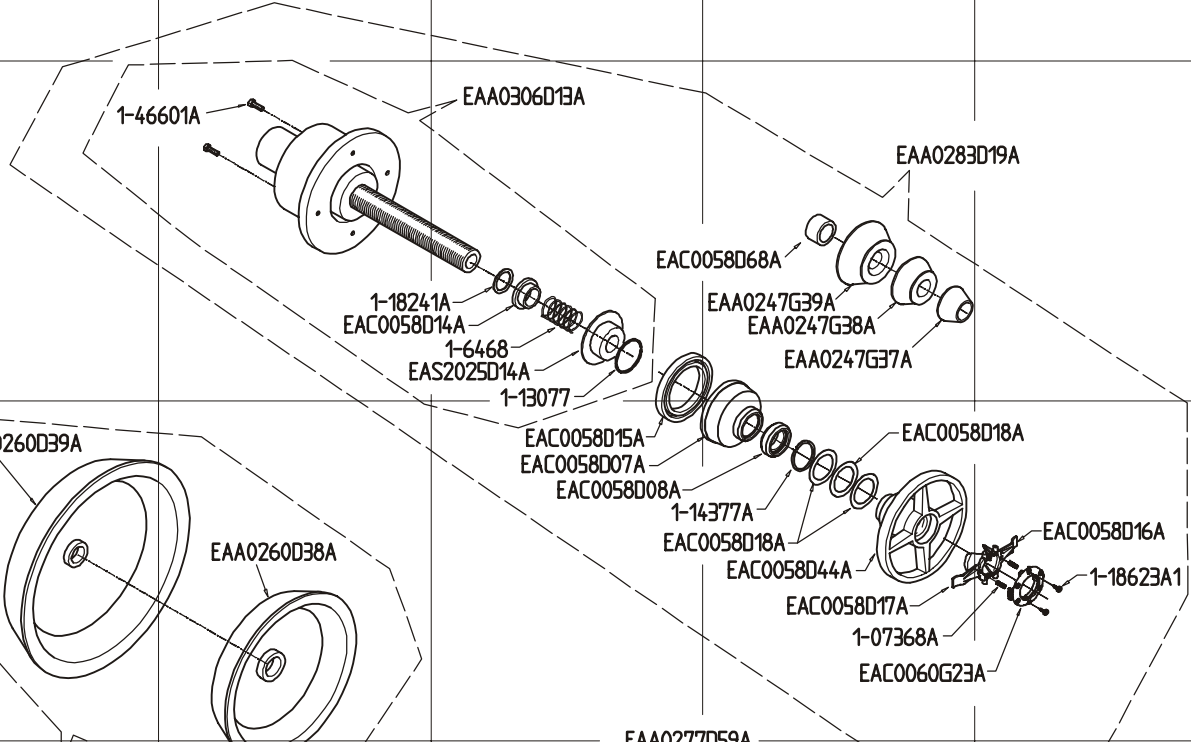

B

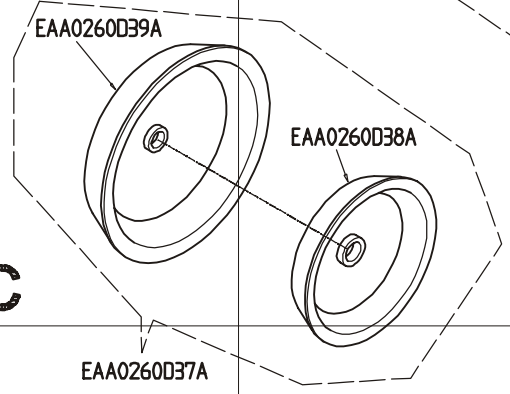

C

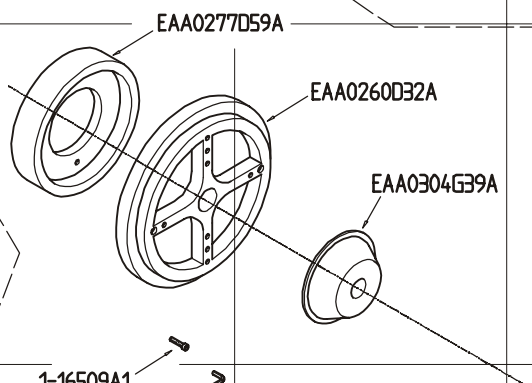

D

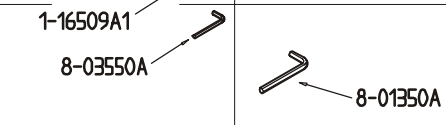

E

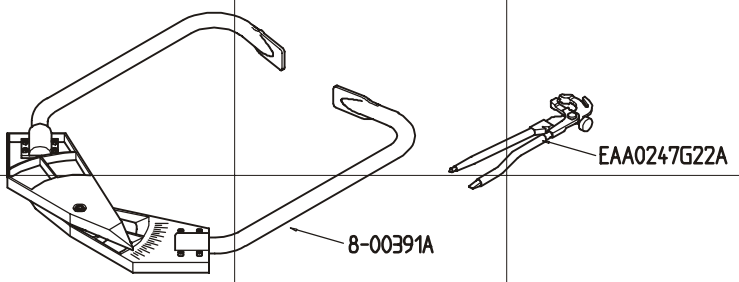

F

**HNA**  
10/2004

<b>Revision B</b>	<b>Differences on previous version.</b>	<b>Différences sur version antérieure.</b>
(from October 2004)	<ul style="list-style-type: none"> <li>- <b>1400.a</b> HWT CODE REPLACED WITH SNAP-ON CODE</li> <li>- <b>1401.a</b> HWT CODE REPLACED WITH SNAP-ON CODE</li> <li>- <b>1402.a</b> HWT CODE REPLACED WITH SNAP-ON CODE</li> <li>- <b>1403.a</b> HWT CODE REPLACED WITH SNAP-ON CODE</li> <li>- <b>1404.a</b> HWT CODE REPLACED WITH SNAP-ON CODE</li> <li>- <b>1405.a</b> HWT CODE REPLACED WITH SNAP-ON CODE</li> <li>- <b>1406.a</b> HWT CODE REPLACED WITH SNAP-ON CODE</li> <li>- <b>1407.a</b> HWT CODE REPLACED WITH SNAP-ON CODE</li> <li>- <b>1454.a</b> HWT CODE REPLACED WITH SNAP-ON CODE</li> </ul>	(à partir d'October 2004) numération HWT remplacé avec numération SNAP-ON numération HWT remplacé avec numération SNAP-ON numération HWT remplacé avec numération SNAP-ON numération HWT remplacé avec numération SNAP-ON numération HWT remplacé avec numération SNAP-ON numération HWT remplacé avec numération SNAP-ON numération HWT remplacé avec numération SNAP-ON numération HWT remplacé avec numération SNAP-ON

**HOFMANN USA**

309 Exchange Ave. Conway, AR 72032 Phone 800-251-4500 Fax 501-450-2085  
[www.hofmann-usa.com](http://www.hofmann-usa.com)

**HOFMANN BALANCING TECHNIQUES LTD. CANADA**

6500 Millcreek Dr. Mississauga, Ontario L5N 4G4 Phone 800-267-2185 Fax 905-821-2073  
[www.hofmann.ca](http://www.hofmann.ca)

**Snap-on Equipment GmbH · Geschäftsbereich Hofmann Werkstatt-Technik · PF 1202 · D-64311 Pfungstadt**  
**Service Tel. +49 6157 12-482 · Fax +49 6157 12-484 · [www.hofmann-ge.com](http://www.hofmann-ge.com) · [service@hofmann-ge.com](mailto:service@hofmann-ge.com)**